

GPE320

Multipole Power Connector

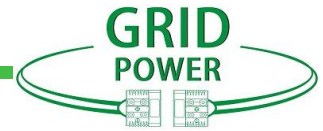

FEATURES

- **Flat wiping contact system**
Minimal contact resistance at high current, wiping action cleans contact surface during connection/disconnection
- **Mechanical keyed housings**
Prevents accidental mating of components operating at different voltage levels
- **Interchangeable genderless design**
Makes assembly easy and reduces stock
- **Ergonomic design**
Is "user friendly" during connection and disconnection of the system

特征

- **平面接触技术**
强电流下接触电阻最小，断开过程中产生的擦拭动作可清洁接触件表面
- **彩色防呆设计**
根据颜色确定行业标准推荐的使用电压，避免两个带有不同电压编码颜色的胶壳配插（消除电源与插座误插的可能性）
- **互换无公母设计**
互换性设计，无公母外壳，利于减少库存
- **人体工学设计**
提供良好的插拔设计

PRODUCT SPECIFICATIONS/产品规格

Current Rating (Amperes) 额定电流 (安培)	320
Voltage Ratings (Volts) 额定电压 (伏特)	150
Contact Barrel Wire Size (AWG) (mm ²) 适用线径 (AWG) (mm ²)	2/0 to 300 mcm 67.4 to 152.0
Maximum Wire Insulation Diameter (inches) (mm) 最大绝缘导线直径 (英寸) (毫米)	1.10 27.9
AVG Contact Resistance (micro-ohms) 接触电阻 (微欧)	50
Insulation Withstanding Test Voltage (Volts AC/DC) 绝缘耐电压 (交流/直流)	2200
Contact Retention Force (lbf) 端子保持力 (磅)	500
Life/寿命 a. No load (Contact/Disconnect Cycles) 无负载 (插拔次数) b. Under Load (Hot Plug 250 cycles @ 120V) 负载状态 (120V 电压执插拔 250 次)	To 10,000 100A
Avg. Connection/Disconnect (lbf) 平均插拔力 (磅)	30
Operating Temperature Range °C °F 工作温度	-20° to 105° -4° to 221°
Flammability Rating of Housing Material 材料防火等级 Plastic (塑胶壳) Polycarbonate Contact (端子) Copper Alloy Silver plating	UL94 V-0

Your Best High Power Connection



Shenzhen Grid Power Connectors Co., Ltd

Tel: +86 0755-23208099 23205933

Address: The 2nd Floor, Building B&C, Plant 1, Senyang, echnology Park, Guangming District, Shenzhen City, PRC

www.gridpower-conn.com www.grd-power.com

GPE320

Multipole Power Connector



HOUSING/胶壳

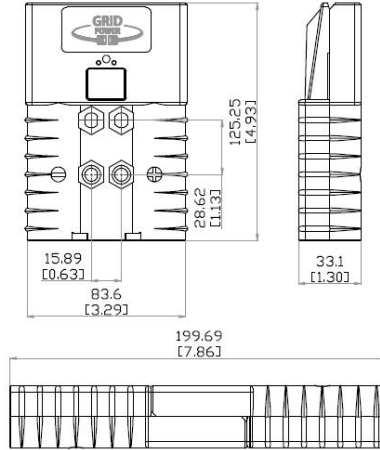

Part Number 料号	Housing Color 胶壳颜色	
GPE320A1G1	Red 红色	
GPE320A1G2	Green 绿色	
GPE320A1G3	Black 黑色	
GPE320A1G4	White 白色	
GPE320A1G5	Blue 蓝色	
GPE320A1G6	Yellow 黄色	
GPE320A1G7	Orange 橙色	
GPE320A1G8	Gray 灰色	
GPE320A1G9	Brown 棕色	
GPE320A1G10	Pink 粉色	
GPE320A1G11	Purple 紫色	

CANTACT/接触件

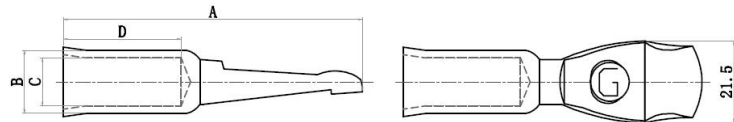

Part Number 料号	Description 描述	Wire Size/线径		- A -		- B -		- C -		- D -	
		AWG	Sq.mm	mm	In	mm	In	mm	In	mm	In
A1	S6394G1 Individual 单粒	2	35	76.96	3.03	12.95	0.51	9.65	0.38	20.57	0.81
A2	S6354G1 Individual 单粒	2/0	70	77.50	3.05	16.30	0.64	12.40	0.49	30.00	1.18
A3	S6355G1 Individual 单粒	3/0	95	78.74	3.10	17.78	0.70	14.73	0.58	20.57	0.81
A4	S6356G1 Individual 单粒	4/0	120	78.74	3.10	19.05	0.75	16.26	0.64	20.57	0.81
A5	S6358G1 Individual 单粒	300 mcm	150	76.96	3.03	22.35	0.88	19.05	0.75	22.35	0.88

Your Best High Power Connection



Shenzhen Grid Power Connectors Co., Ltd

Tel: +86 0755-23208099 23205933

Address: The 2nd Floor, Building B&C, Plant 1, Senyang, echnology Park, Guangming District, Shenzhen City, PRC

www.gridpower-conn.com www.grd-power.com

GPE320

Multipole Power Connector

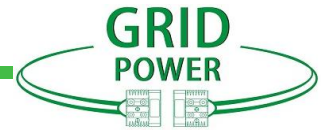

HANDLE/拉手

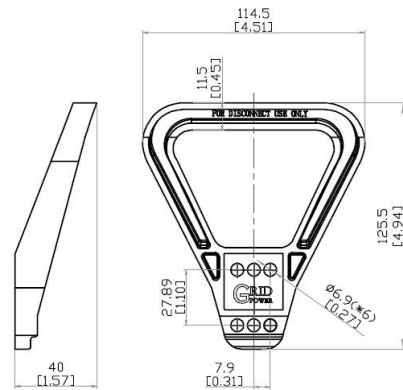
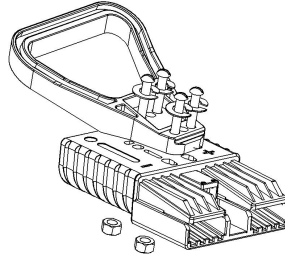

Part Number/料号	Color/颜色
G995G1	Gray 灰色
G995G4	Red 红色
G995	Black 黑色

GPX4P HOUSING/GPX4P 胶壳

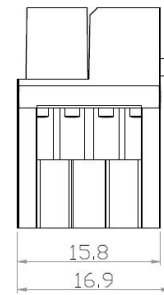
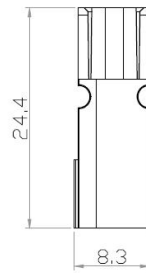
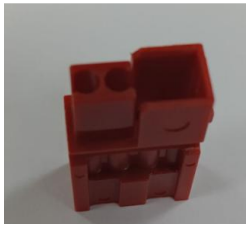

Part Number/料号	Color/颜色
GPX4PG2	Red 红色
GPX4PG1	Black 黑色

PIN CONTACTS FOR GPX4P AUXILIARY/信号针

Part Number 料号	Description 描述	Wire Size/线径		-L-		-L1-		-ID-	
		AWG	sq. mm	mm	In.	mm	In.	mm	In.
SPM16P12S30	Standard Length 7.7mm	#12	3.3	19.5	0.77	7.7	0.30	2.6	0.10
SPM16P1416S30		#14/#16	1.5/1.0	19.5	0.77	7.7	0.30	2.1	0.08
SPM16P1620S30		#16/#20	1.0/0.75	19.5	0.77	7.7	0.30	1.7	0.07
SPM16P2024S30		#20/#24	0.75/0.5	19.5	0.77	7.7	0.30	1.1	0.04
SPM16P12A30	Pre-Mate 9.3mm	#12	3.3	21.2	0.83	9.3	0.37	2.6	0.10
SPM16P1416A30		#14/#16	1.5/1.0	21.2	0.83	9.3	0.37	2.1	0.08
SPM16P1620A30		#16/#20	1.0/0.75	21.2	0.83	9.3	0.37	1.7	0.07
SPM16P2024A30		#20/#24	0.75/0.5	21.2	0.83	9.3	0.37	1.1	0.04
SPM16P12C30	Post-Mate 6.4mm	#12	3.3	18.3	0.72	6.4	0.25	2.6	0.10
SPM16P1416C30		#14/#16	1.5/1.0	18.3	0.72	6.4	0.25	2.1	0.08
SPM16P1620C30		#16/#20	1.0/0.75	18.3	0.72	6.4	0.25	1.7	0.07
SPM16P2024C30		#20/#24	0.75/0.5	18.3	0.72	6.4	0.25	1.1	0.04

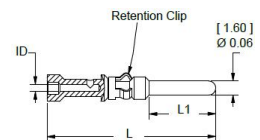

Your Best High Power Connection



Shenzhen Grid Power Connectors Co., Ltd

Tel: +86 0755-23208099 23205933

Address: The 2nd Floor, Building B&C, Plant 1, Senyang, echnology Park, Guangming District, Shenzhen City, PRC

www.gridpower-conn.com www.grd-power.com

GPE320

Multipole Power Connector



SOCKET CONTACTS FOR GPX4P AUXILIARY/信号针

Part Number 料号	Description 描述	Wire Size/线径		-ID-	
		AWG	sq. mm	mm	In.
SPM16S12S32	Socket Contact	#12	3.3	2.6	0.10
SPM16S1416S32		#14/#16	1.5/1.0	2.1	0.08
SPM16S1620S32		#16/#20	1.0/0.75	1.7	0.07
SPM16S2024S32		#20/#24	0.75/0.5	1.1	0.04

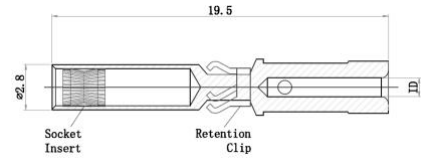

TEMPERATURE RISE CHARTS/温升测试

GPE320
Temperature Rise at Constant Current/温升曲线

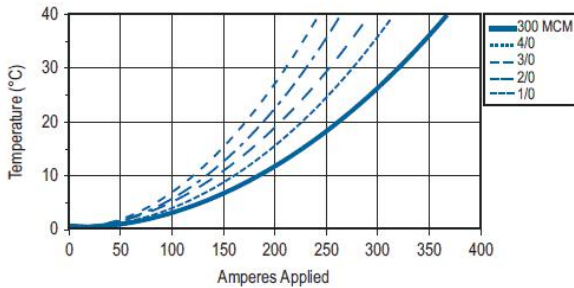

GPE320
Pulse Current Capability/脉冲电流

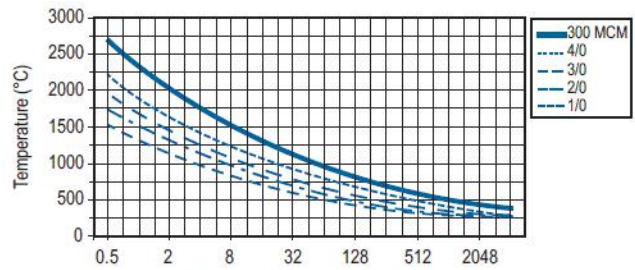

INSERT TOOL/送针器



Part Number 料号

75x10001

Accessories/附件

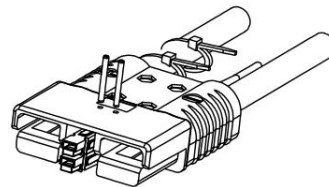
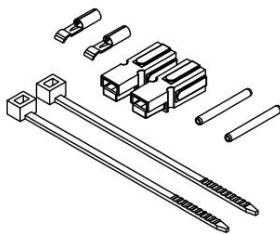

Part Number/料号	Description 描述
G6344	G1327、G1327G6、S1331、G110G9、H1509P12

Your Best High Power Connection



Shenzhen Grid Power Connectors Co., Ltd

Tel: +86 0755-23208099 23205933

Address: The 2nd Floor, Building B&C, Plant 1, Senyang, echnology Park, Guangming District, Shenzhen City, PRC

www.gridpower-conn.com www.grd-power.com