

GPE 160

Multipole Power Connector

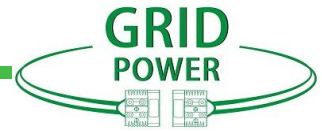

FEATURES

特征



• Flat wiping contact system

Minimal contact resistance at high current, wiping action cleans contact surface during connection/disconnection

•平面接触技术

强电流下接触电阻最小，断开过程中产生的擦拭动作可清洁接触件表面

• Colored modular housings

Color designates recommended application voltage per industry standards Prevents accidental mating of components operating at different voltage levels

•彩色模块化外壳

根据颜色确定行业标准推荐的使用电压,避免两个带有不同电压编码颜色的胶壳配插((消除电源与插座误插的可能性)

• Touch safe interface

Minimizes potential contact with live circuits per IEC60950

•防金手指设计

大大降低了生活中电路的潜在风险,依照 IEC60950 标准

• Interchangeable genderless design

Makes assembly easy and reduces stock

•互换无公母设计

互换性设计，无公母外壳，利于减少库存

PRODUCT SPECIFICATIONS/产品规格

Current Rating (Amperes) 额定电流 (安培)	160
Voltage Ratings (Volts) 额定电压 (伏特)	150
Contact Barrel Wire Size(AWG) 适用线径(AWG) (m m ²) (m m ²)	1/0 to 35mm 53.5 to 35
Maximum Wire Insulation Diameter(inches) 最大绝缘导线直径(英寸) (mm) (毫米)	0.75 19.1
AVG Contact Resistance(micro-ohms) 接触电阻 (微欧)	100
Insulation Withstanding Test Voltage (Volts AC/DC) 绝缘耐电压 (交流/直流)	2200
Contact Retention Force (lbs) 端子保持力(磅)	300
Life/寿命 a. No load (Contact/Disconnect Cycles) 无负载 (插拔次数) b. Under Load (Hot Plug 250 cycles @ 120V) 负载状态 (120V 电压执插拔 250 次)	To 10,000 75A
Avg. Connection/Disconnect (lbf) 平均插拔力 (磅)	25
Operating Temperature Range °C 工作温度 °C °F °F	-20° to 105° -4° to 221°
Flammability Rating of Housing Material 材料防火等级 Plastic(塑胶壳) Polycarbonate Contact(端子) Copper Alloy Silver plating	UL94 V-0

Your Best High Power Connection



Shenzhen Grid Power Connectors Co., Ltd

Tel: +86 0755-23208099 23205933

Address: The 2nd Floor, Building B&C, Plant 1, Senyang, Technology Park, Guangming District, Shenzhen City, PRC

www.gridpower-conn.com www.grd-power.com

GPE 160

Multipole Power Connector



HOUSING/胶壳

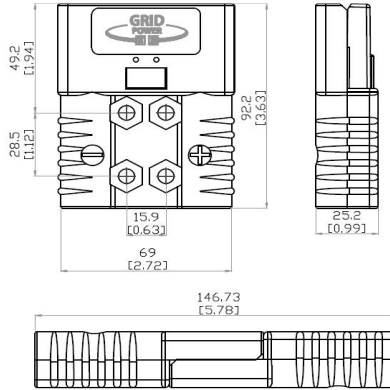

Part Num 料号	Description 描述	
GPE160G2	RED 红色	
GPE160G3	GREEN 绿色	
GPE160G4	GRAY 灰色	
GPE160G1	BLACK 黑色	
GPE160G5	BLUE 蓝色	

CANTACT/接触件

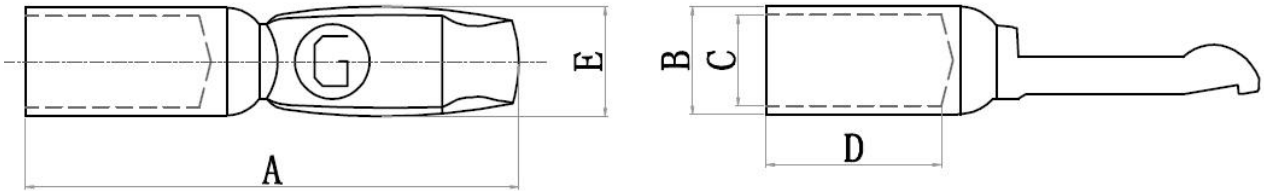

Part Num 料号	Description 描述	Mating Force 配合力	Wire Size/线径		-A-		-B-		-C-		-D-		-E-	
			AWG	Sq. mm	mm	In.	mm	In.	mm	In.	mm	In.	mm	In.
S6384G1	Silver Plated 镀银	High 高	1/0	53.5	60.5	2.38	13.1	0.52	11	0.43	21.5	0.86	13.13	0.52
S6384G2	Silver Plated 镀银	High 高	N/A	35	60.5	2.38	13.1	0.52	9	0.35	21.5	0.86	13.13	0.52
S6384G3	Silver Plated 镀银	Low 低	1/0	53.5	60.5	2.38	13.1	0.52	11	0.43	21.5	0.86	13.13	0.52

BUSBAR/接触件

Part Num 料号	Description 描述
GPX175BBS-123	Silver Plated 镀银

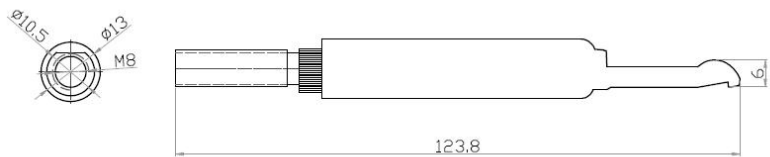

Part Num 料号	Description 描述
GPX175BBS-110	Silver Plated 镀银

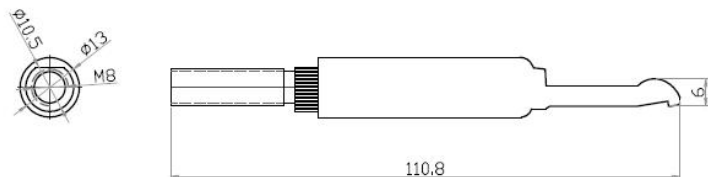

Your Best High Power Connection



Shenzhen Grid Power Connectors Co., Ltd

Tel: +86 0755-23208099 23205933

Address: The 2nd Floor, Building B&C, Plant 1, Senyang, Technology Park, Guangming District, Shenzhen City, PRC

www.gridpower-conn.com www.grd-power.com

GPE 160

Multipole Power Connector

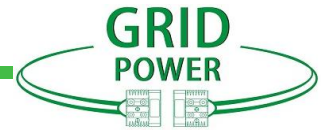

HANDLE/拉手

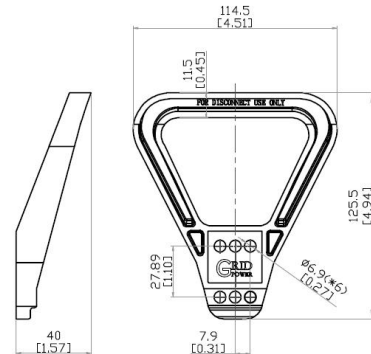

Part Number/料号	Color/颜色	
G995G1	Gray 灰色	
G995G3	Red 红色	
G995	Black 黑色	

GPX4P HOUSING/GPX4P 胶壳

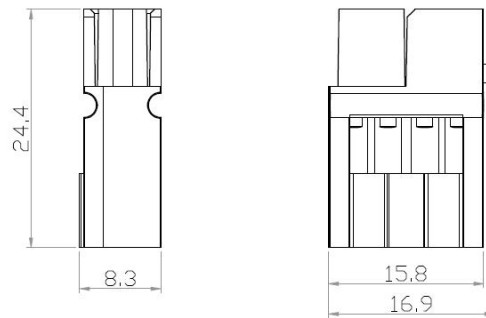
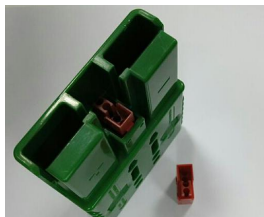

Part Number/料号	Color/颜色	
GPX4PG2	Red 红色	
GPX4PG1	Black 黑色	

PIN CONTACTS FOR GPX4P AUXILIARY/信号针

Part Number 料号	Description 描述	Wire Size/线径		-L-		-L1-		-ID-	
		AWG	sq. mm	mm	In.	mm	In.	mm	In.
SPM16P12S30	Standard Length 7.7mm	#12	3.3	19.5	0.77	7.7	0.30	2.6	0.10
SPM16P1416S30		#14/#16	1.5/1.0	19.5	0.77	7.7	0.30	2.1	0.08
SPM16P1620S30		#16/#20	1.0/0.75	19.5	0.77	7.7	0.30	1.7	0.07
SPM16P2024S30		#20/#24	0.75/0.5	19.5	0.77	7.7	0.30	1.1	0.04
SPM16P12A30	Pre-Mate 9.3mm	#12	3.3	21.2	0.83	9.3	0.37	2.6	0.10
SPM16P1416A30		#14/#16	1.5/1.0	21.2	0.83	9.3	0.37	2.1	0.08
SPM16P1620A30		#16/#20	1.0/0.75	21.2	0.83	9.3	0.37	1.7	0.07
SPM16P2024A30		#20/#24	0.75/0.5	21.2	0.83	9.3	0.37	1.1	0.04
SPM16P12C30	Post-Mate 6.4mm	#12	3.3	18.3	0.72	6.4	0.25	2.6	0.10
SPM16P1416C30		#14/#16	1.5/1.0	18.3	0.72	6.4	0.25	2.1	0.08
SPM16P1620C30		#16/#20	1.0/0.75	18.3	0.72	6.4	0.25	1.7	0.07
SPM16P2024C30		#20/#24	0.75/0.5	18.3	0.72	6.4	0.25	1.1	0.04

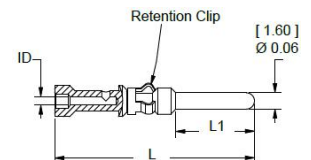

Your Best High Power Connection



Shenzhen Grid Power Connectors Co., Ltd

Tel: +86 0755-23208099 23205933

Address: The 2nd Floor, Building B&C, Plant 1, Senyang, Technology Park, Guangming District, Shenzhen City, PRC

www.gridpower-conn.com www.grd-power.com

GPE 160

Multipole Power Connector

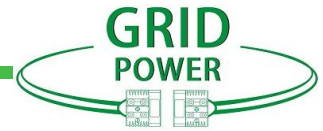

SOCKET CONTACTS FOR GPX4P AUXILIARY/信号针

Part Number 料号	Description 描述	Wire Size/线径		-ID-	
		AWG	sq. mm	mm	In.
SPM16S12S32	Socket Contact	#12	3.3	2.6	0.10
SPM16S1416S32		#14/#16	1.5/1.0	2.1	0.08
SPM16S1620S32		#16/#20	1.0/0.75	1.7	0.07
SPM16S2024S32		#20/#24	0.75/0.5	1.1	0.04

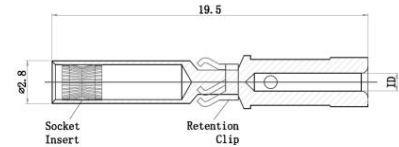

TEMPERATURE RISE CHARTS/温升测试

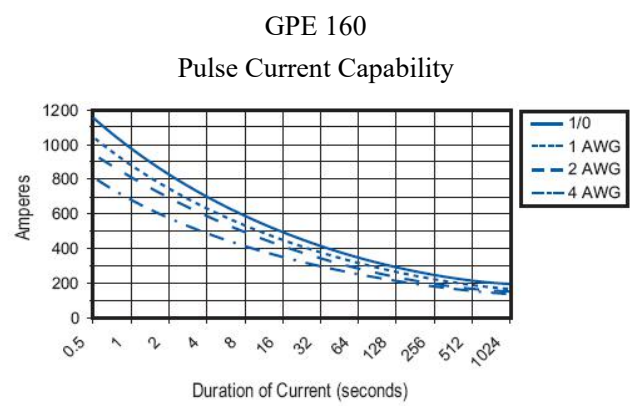
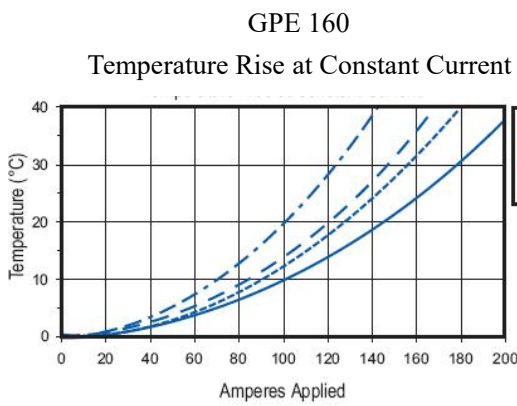

INSERT TOOL/送针器



Part Number 料号
75x10001

Accessories/附件

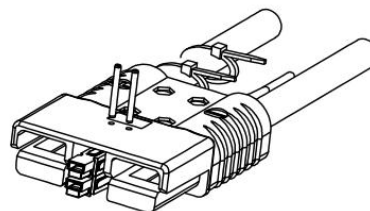
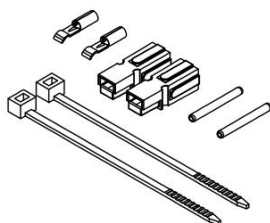

Part Number/料号	Description 描述
G6344	G1327 、 G1327G6 、 S1331 、 G110G9 、 H1509P12

Your Best High Power Connection



Shenzhen Grid Power Connectors Co., Ltd

Tel: +86 0755-23208099 23205933

Address: The 2nd Floor, Building B&C, Plant 1, Senyang, Technology Park, Guangming District, Shenzhen City, PRC

www.gridpower-conn.com www.grd-power.com